

**UK**

Phillips or flat head screwdriver and drill required.

**E**

Necesario utilizar un destornillador y un taladro.

**P**

É necessário utilizar uma chave de fendas e uma broca.

**F**

Un tournevis Phillips ou pour vis plate, ainsi qu'une perceuse sont nécessaires.

**I**

Sono necessari una cacciavite normale o a stella e un trapano.

**D**

Hierfür sind ein Phillips- oder Iackkopfschraubenzieher und ein Bohrer erforderlich.

**NL**

Een philips schroevendraaier and boor is nodig voor bevestiging.

**DK**

Kræver stjærneskrueetrækker eller flad skrueetrækker og bor.

**S**

Philips stjärnskruvmejsel eller vanlig skruvmejsel och bormaskin.

**N**

Du trenger en Phillips- eller annen skrutrekker med flatt hode og en drill.

**FIN**

Vaatii ristipääruuvitaltan tai tavallisen ruuvitaltan ja poran käyttöä.

**中**

组装过程需用到适合的螺丝刀或钻具。

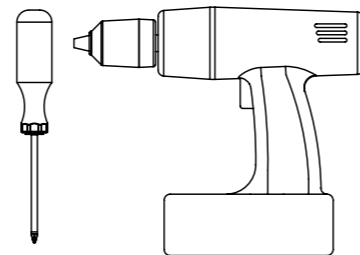

**Parts check list**  
**Lista de las piezas**  
**Lista de peças**  
**Lista des pièces**  
**Componenti**  
**Teilliste**  
**Onderdelenlijst**  
**Reservedelsliste**  
**Lista över delarna**  
**Deleliste**  
**Osat**

附件清单

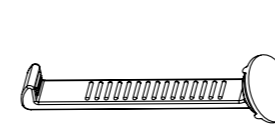

x 4

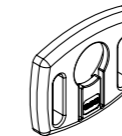

x 4

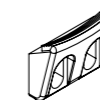

x 4



x 16

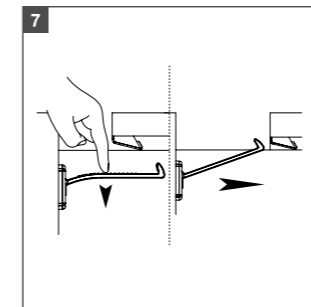
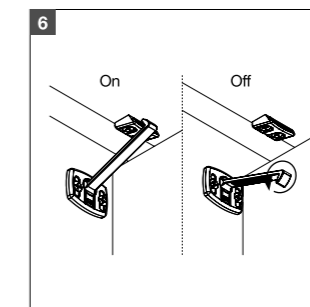
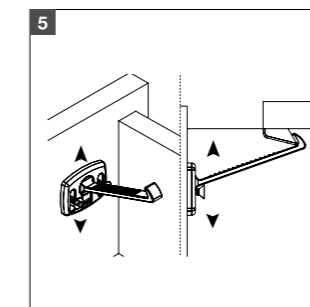
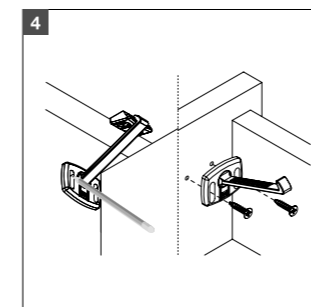
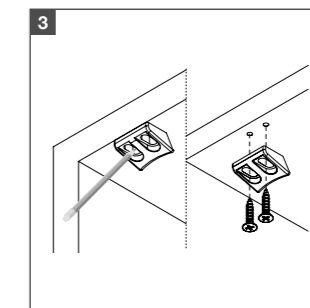
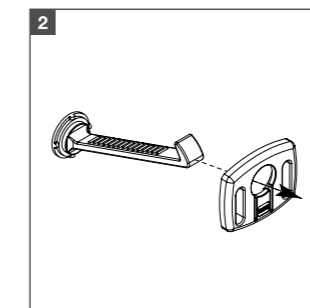
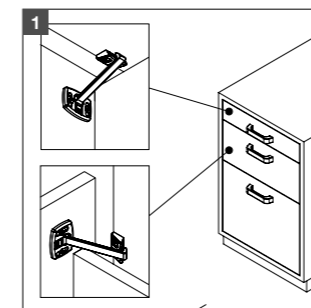

# On/off Drawer cupboard lock

- UK** On/off Drawer/cupboard lock
- E** Cierre Cajón/Armario Interior "on/off"
- P** Fecho Gaveta/Armário Interior "on/off"
- F** Bloque tiroir/porte "on/off"
- I** Blocca cassetti/armadi "on/off"
- D** Auf-/zu-Schubladen- und Schrankverschluss
- NL** On/off Lade- kastdeurslot
- DK** On/off Skuffe-/skabssikring
- S** På/av Låd- och skåpregel
- N** På/av Skuff- og skapsikring
- FIN** Laatikkolukko "on/off"
- 中** 抽屉及柜门安全锁

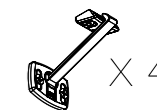

3001-376KA

Baby Dan A/S  
 Niels Bohrs Vej 14  
 DK-8670 Låsby  
 Tel + 45 86 95 11 55  
 Fax + 45 86 95 15 91  
 www.babydan.com  
 info@babydan.com

**Baby Dan**

Safety

www.babydan.com

